

PER33 Planar High Current Power Inductor

平面大电流功率电感

Features 特点

- Flat wire windings provide extremely low DC and AC resistance.
扁平绕组提供极低的直流和交流电阻
- Low radiation noise by magnetically shielded construction
闭合磁路封装，低辐射
- High temperature ferrite core
高温铁氧体磁芯
- Operating temperature : -40°C~+125°C.
工作温度：-40°C~+125°C
- Moisture Sensitivity Level (MSL) 1 (unlimited floor life at <30°C / 85% relative humidity)
湿气敏感度等级 (MSL) 1 (在 <30° C 时的无限车间寿命/ 85% 相对湿度)

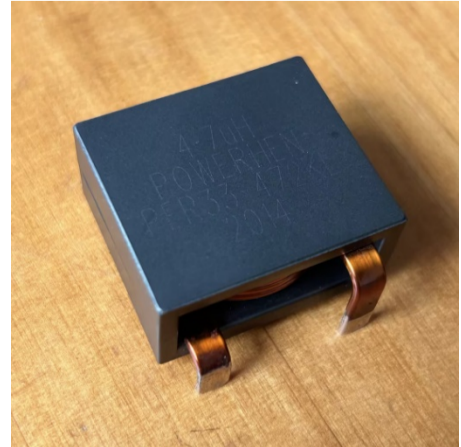

Applications 应用

- Energy storage chokes for 储能扼流圈
- Buck/boost choke for 48 V boardnet converter. 用于 48V 转换降压/升压扼流圈
- Filter for audio applications. 音频滤波应用
- DC-DC converters. 直流/直流转换器

Electrical characteristics 电气特性

Part number 料号	Inductance① 电感量 μH±10%	DCR ② 直流电阻 mΩ		SRF③ 自谐振频率 MHz		Isat④ 饱和电流 A typ			Irms⑤ 温升电流 A max.	
		Typ	Max.	typical	10% drop	20% drop	30% drop	20°C rise	40°C rise	
PER33-102KE	1.0	0.76	0.85	39	222	230	232	58	72	
PER33-222KE	2.2	1.11	1.2	23	141	148	149	46	59	
PER33-322KE	3.2	0.76	0.85	18	95	112	114	58	72	
PER33-352KE	3.5	1.11	1.2	17	81	87	88	46	59	
PER33-472KE	4.7	1.11	1.2	16	77	82	82.8	46	59	
PER33-502KE	5.0	1.11	1.2	15	73	78	79.2	46	59	
PER33-562KE	5.6	1.11	1.2	14	59	63	63.5	46	59	
PER33-602KE	6.0	1.11	1.2	12.5	58	62	62.8	46	59	
PER33-682KE	6.8	1.11	1.2	12	51	56	57	46	59	
PER33-822KE	8.2	1.11	1.2	10	39	43	44	46	59	
PER33-103KE	10	1.11	1.2	9	32	36	36.6	46	59	

Remark

- ① Inductance is measured with a LCR meter Agilent 4284A or equivalent. Test frequency at 100kHz
- ② DC resistance is measured with Keithley 580 Milliohm Meter, or equivalent. Reference ambient temperature 25°C
- ③ SRF measured using an Agilent 4395A network analyzer and an Agilent 16193A test fixture.
- ④ DC current at 25°C that causes the specified Inductance drop from its value without current.
- ⑤ Current that causes the specified temperature rise from 25°C ambient. This information is for reference only and does not represent absolute maximum ratings.
- ⑥ Electrical specifications at 25°C

备注

- ① 电感量测试采用 Agilent 4284A 数字电桥或同等仪器；测试频率 100KHz
- ② 直流电阻测试采用 Keithley 580 毫欧表或同等仪器；环境温度 25° C
- ③ SRF 使用 Agilent 4395A 网络分析仪和 Agilent 16193A 测试夹具测量。
- ④ 直流电流在 25° C，加载导致指定电感从没有电流的值下降。
- ⑤ 导致指定温度从 25° C 环境温度上升的电流。此信息仅供参考，不代表绝对最大额定值。
- ⑥ 25° C 时的电气规格

Dimensions 结构尺寸

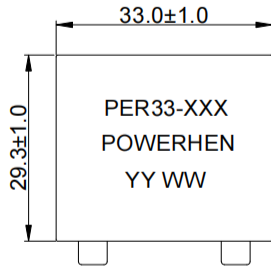

T:

PER33-102KL	1.5mm
PER33-322KL	1.5mm
PER33-222KL	1.25mm
PER33-352~103KL	1.25mm

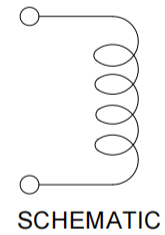
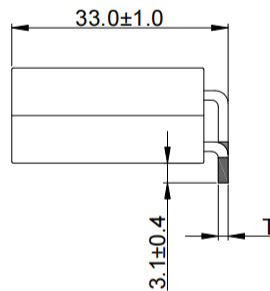
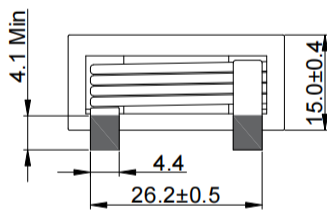

Electrical Characteristic Curve 电气特性曲线

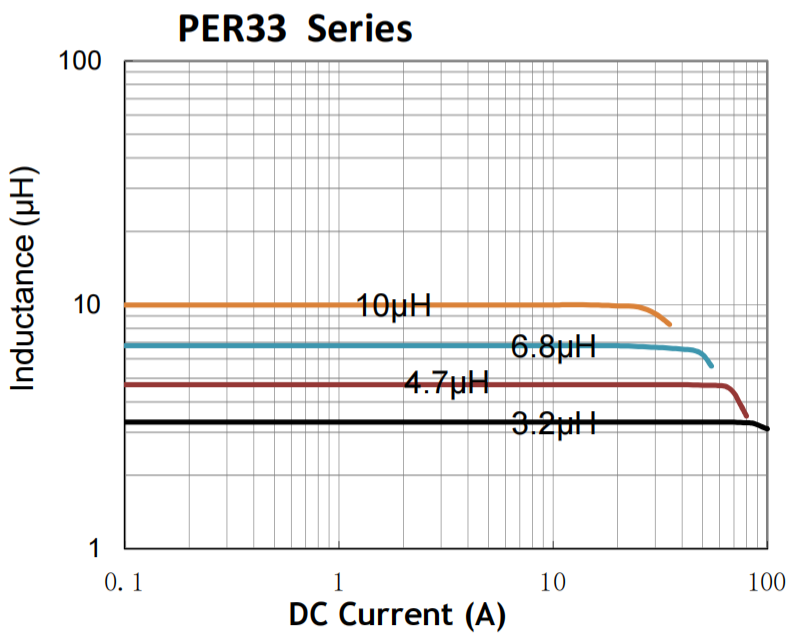

■ Packaging Specification - tray: [mm]

包装规格 - 托盘包装: [mm]

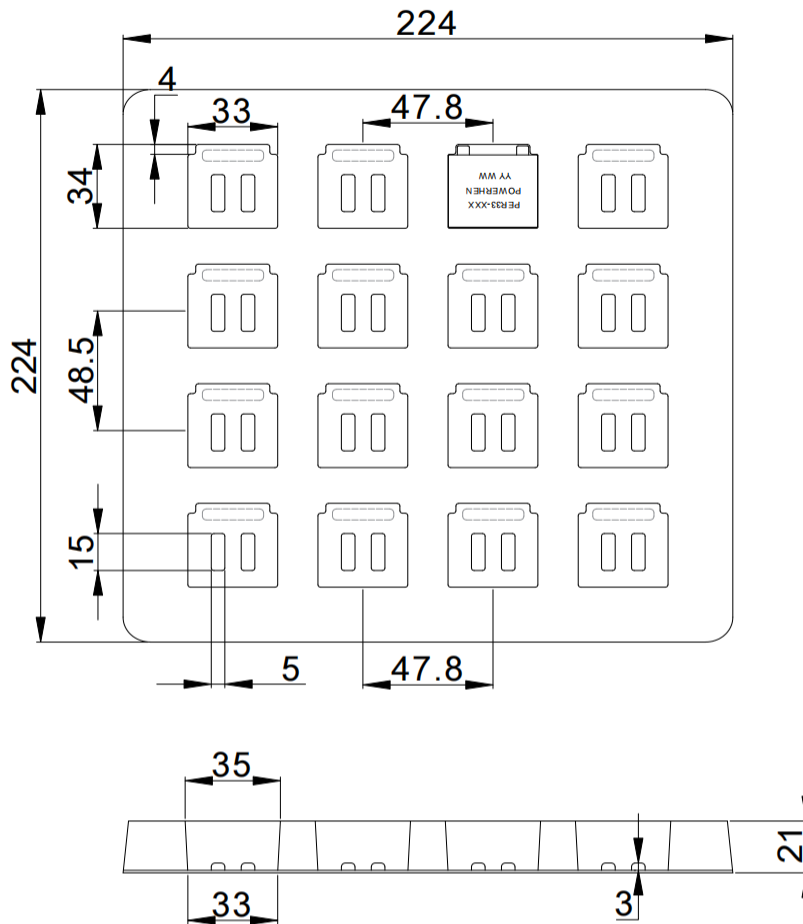

Weight 重量: 60g~62g/PCS
 Packaging 包装数量: 36 PCS/盘